

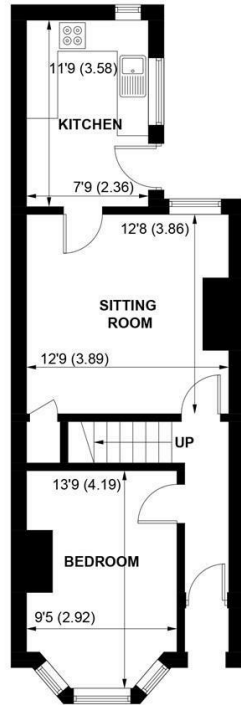

93 HIGHFIELD ROAD, BOGNOR REGIS, WEST SUSSEX, PO22 8PD

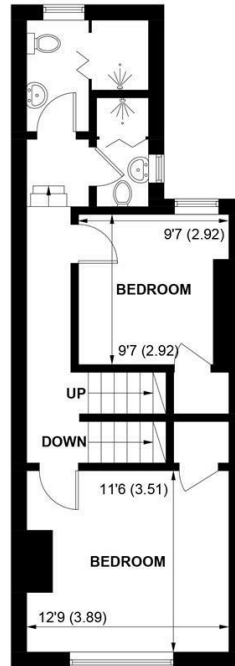

GROUND FLOOR



FIRST FLOOR

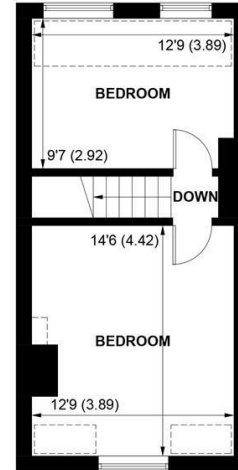

SECOND FLOOR

APPROXIMATE GROSS INTERNAL AREA = 1257 SQ FT / 116.8 SQ M

**NOT TO SCALE (For illustrative purposes only as defined by RICS Code of Measuring Practice) 2025 ©
Produced for Sims Williams**

£325,000 Freehold

93, HIGHFIELD ROAD,
BOGNOR REGIS,
WEST SUSSEX, PO22 8PD

- Terraced House
- Five Bedrooms Across Three Floors
- One Reception Room
- Newly Installed Kitchen
- Private Garden With Decking Area
- Ideal First Time Purchase Or Investment
- Property Let Till August 2025
- Close to Local Amenities
- Chain Free

EPC RATING

Current = D
Potential = B

COUNCIL TAX BAND

Band = C

Sales & Lettings offices in Arundel, Bognor Regis, Chichester & Walberton

